

# YY-39xx Series Instruction Manual

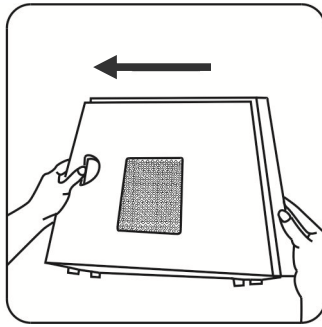

## Opening Chassis

- Release screws on the back of chassis.
- Push the left cover toward rear of the chassis and lift up.
- Same procedure to the right cover.

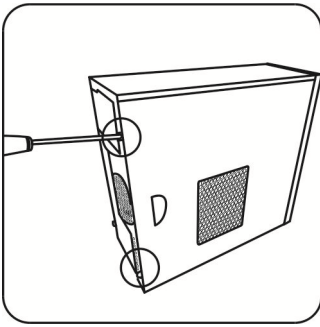
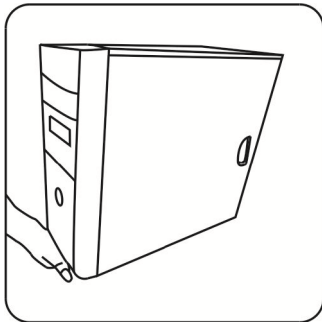

## How to remove the front panel

- After removing the side cover and 5.25" device
- Hold the bottom of front panel and pull out.

**Reminder:** Before assembly exposed drives, the bezels shall be removed from front panel

## Installing MB and Add-on cards

- To check the mounting hole of the mainboard, screw on the optional standoffs into chassis.
- To install the I/O shield provided with mainboard, insert it from inside of chassis towards outside.
- Fix motherboard with screws.
- Insert add-on card into slot and fix with screw.

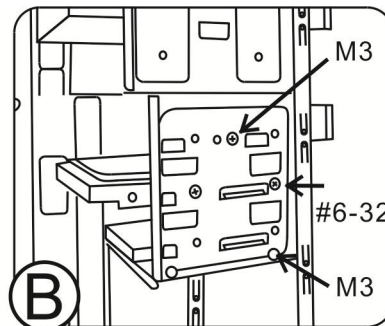
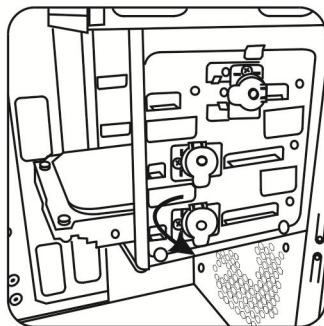
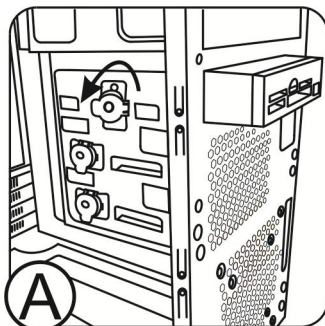

## Installing 3.5" devices, 3.5"HDD, 2.5"HDD

(A)

- Open the fastener as picture shown.
- Insert the 3.5" device into the 3.5" drive bay, until in correct position (hole to hole). Depress the fastener tightly.

(B)

- Screw on the card reader with M3 type screws(4pcs)
- Screw on the 3.5"HDD with #6-32 screws(4pcs)
- Screw on the 2.5"HDD with M3 type screws(4pcs)

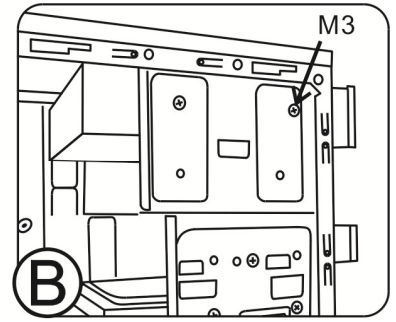
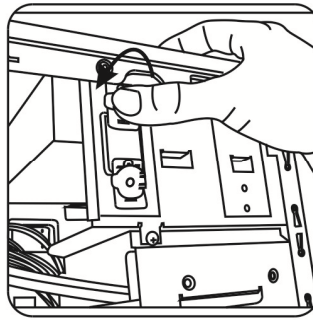
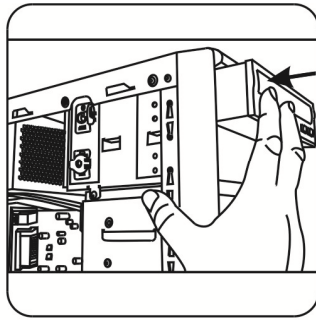
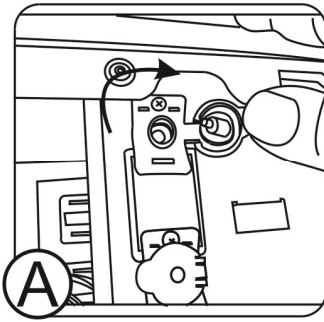

### Installing 5.25" devices

#### (A)

- Make sure the front panel on the chassis.
- Open the fastener as marked direction.
- Insert the 5.25" device into the 5.25" drive bay until in correct position (hole to hole). Depress the fastener tightly.

#### (B)

- Screw on the 5.25" device with M3 type screws(4pcs).

### Cables mounting / connectors

- The pin out of USB3.0&USB2.0, AUDIO headers provided by chassis is compliant with FPIO spec of [www.formfactors.org](http://www.formfactors.org). Before connecting the cables, please check pin arrangement information on the mainboard manual.

### Security lock

The chassis is designed with Padlock bracket, Kensington Slot hole and optional intrusion switch on the rear side.

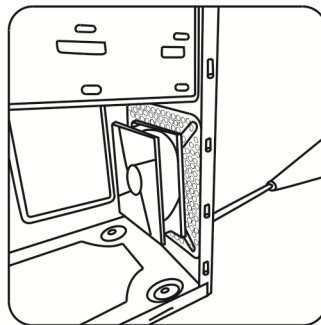
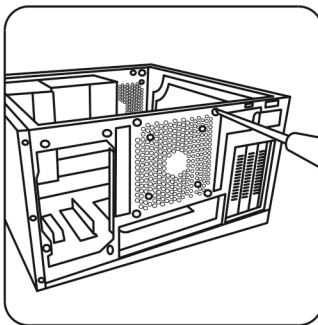

### Cooling Fan assembly

An optional 8cm or 12cm cooling fan could be assembly in the rear end of chassis, and 8cm or 12cm cooling fan for front end.